

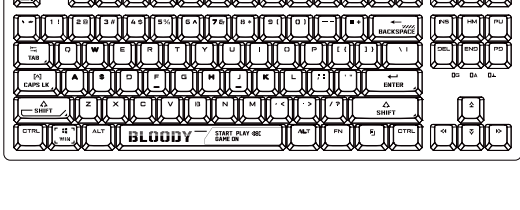

AT87

QUICK START GUIDE



WHAT'S IN THE BOX

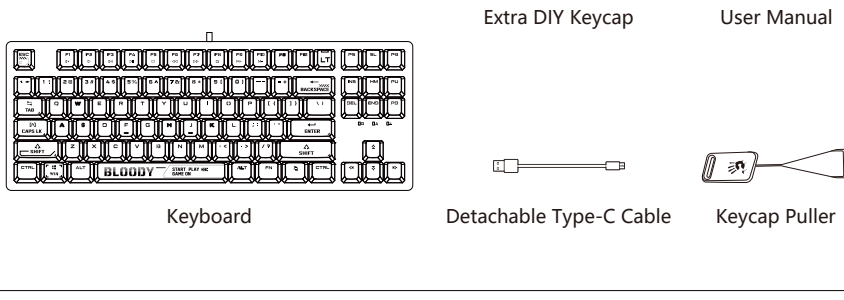

KNOW YOUR PRODUCT



- 1 FN Multimedia Hotkeys
- 2 LT 4 Level Variable Speed Keys
- 3 Light Effect Profiles
- 4 eXact Reset Function Switch
- 5 Backlit Brightness Adjustment

INSTALLATION



Connect the cable Type-C plug to the keyboard and the USB plug to the computer.
(Note: Using a USB hub or extension cable to connect is not recommended.)

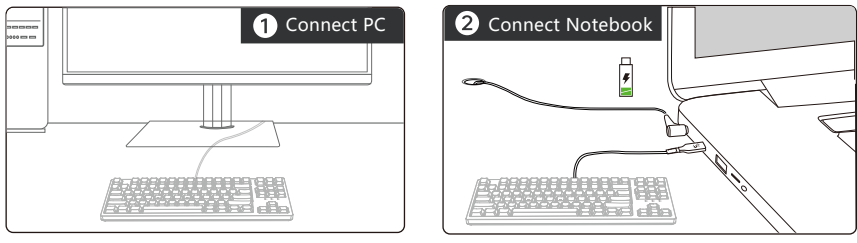

CUSTOMIZABLE LT VARIABLE SPEED PROFILES

Switch between 4 customization actuation levels. With the software, customize up to 23 actuation points (0.8mm to 3.0mm) for all keys or individual keys, creating fully personalized profiles.

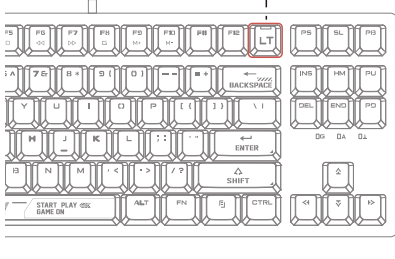

- Software Customization**
4-Level Variable Speed
- Gamer 1 Full Keys Customization
 - Gamer 2 Full Keys Customization
 - Gamer 3 Full Keys Customization
 - Gamer 4 Full Keys / Independent Key Customization

EXACT RESET SYSTEM



When Hyper Z-Force Mode or Extreme X-Force Mode is enabled, the reset occurs at a much shorter distance, allowing for quicker key presses and improving overall responsiveness. This enhances reaction time and performance in various gaming scenarios.

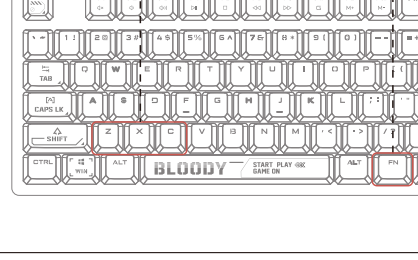

Shortcuts	Function
+	Z-Force Rapid Trigger 0.3mm reset for ultra-fast speed and precision.
+	X-Force Rapid Trigger 0.8mm reset for balanced speed and control.
+	Disable Reset System Deactivates the advanced reset modes.

KEYDOMINATOR EDITING SOFTWARE

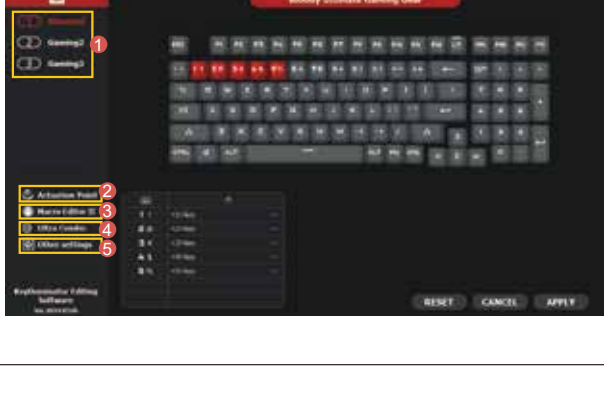

SOFTWARE DOWNLOAD



For optimal product performance and access to advanced customization features, please download and install the software from <http://bloody.com/en/download.php>.

- 1 Keystroke Setting**
Customize keyboard function emulation, programmed keys, shortcut keys, and other settings to suit your preferences.
- 2 Actuation Point**
Fine-tune the travel distance setting of LT optical switches for accurate typing and gaming experiences.
- 3 Macro Editor II**
A player-centric programming platform tailored for users with programming expertise.
- 4 Combination Setting**
A user-friendly player programming platform ideal for players without programming expertise, allowing for the creation of simple programming functions.
- 5 Ultra Combo**
Access settings for advanced software and hardware functions.

FULL KEYBOARD AREA CUSTOMIZATION



Access **LT Optical Travel Configuration** setting by clicking 'Actuation Point' in the software.

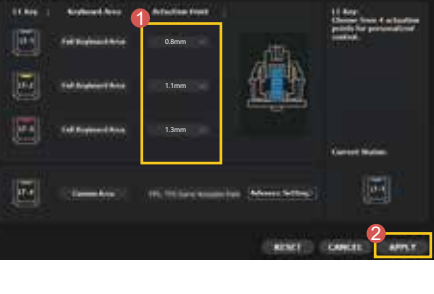

Configuration Example: Adjust the factory preset travel distances for LT-1, LT-2, and LT-3 to 2.6mm, 1.8mm, and 1.6mm respectively.

- 1 Locate 'Actuation Point' in the software interface. Customize the **LT Key** actuation points according to the following steps:
A: Select 2.6mm from 0.8mm for LT-1.
B: Select 1.8mm from 1.1mm for LT-2.
C: Select 1.6mm from 1.3mm for LT-3.
- 2 Click (APPLY), then press the (B) button to switch between the three saved full keyboard area actuation points without needing extra drivers.

FULL-KEY INDEPENDENT CUSTOMIZATION



Access **LT Optical Travel Configuration** setting by clicking 'Actuation Point' in the software.

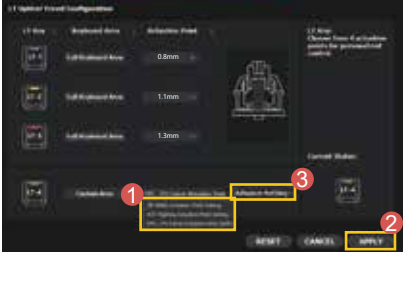

Configuration Example: Customize the LT-4 default actuation point template to create a highly personalized game profile.

- 1 Go to **Custom Area** to set the default actuation point template for the gaming category.
- 2 Click (APPLY), then use the (B) button to toggle between the saved full-key independent variable speed actuation points without additional drivers.
- 3 Click on 'Advanced Setting' to access the actuation point editing platform and adjust the speed of both full-key and independent key actuation points for the game template.

ALPHA PLAYER CUSTOMIZATION



Game Template Configuration Example: Customize the actuation points of the WASD and space keys to 1.4mm while setting other keys to 2.0mm.

- 1 Go to 'Travel Distance' to name your **Game Actuation Point** template. Once confirmed, a game template will be automatically generated. Then, proceed to adjust the **Full Keyboard Area** setting.
- 2 Set the **Full Keyboard Area** to 2.0mm, then proceed to configure the Single or Multiple Key settings.
- 3 Select **W/S/A/D** and the **<SPACE>** key to designate the actuation point as 1.4mm:
a Red key: Set the independent key actuation point to 1.4mm
b Black key: Set the full key actuation point to 2.0mm
- 4 Save in **File Management**, the current edited game template will be saved.



COMBINATION FN KEYS



- FN + Default 7 Preset RGB Lighting Effects
- FN + Mute Volume - Volume + Play/Pause Stop Previous Next
- FN + / Previous / Next Macro Profile
- FN + / Disable "Windows" Key
* The G LED in Solid Light
- FN + / Lighting Brightness +/-

Q & A



Question Can I switch the actuation points without software?

Answer You may customize and save 4-level actuation points through the software, switch them by driver-free.

Question What are the types of the actuation points settings?

Answer With the software, customize the actuation points for all keys or individual keys, creating fully personalized profiles.

Question Can I restore the factory default settings for the 4 LT speeds?

Answer Click the [Reset] Button in the software to restore the factory default settings.

Question How to adjust the lighting brightness?

Answer Adjust the backlit with 3-level brightness and off by pressing + /

TECH SPEC



Switch Type	Alpha Optical Variable Speed Switch
Adjustable Actuation Point	23 Options 0.8mm~3.0mm
2-Stage RT Function	RT1: 0.3mm, RT2: 0.8mm
Number of Keys	87 Keys + 1 LT Variable Speed Key
Switch Lifetime	100 Million Keystrokes
Report Rate	1000 Hz
Onboard Memory	4M
RGB Backlit Effect	7 Lighting Effects
100% N-Key Rollover	Yes
Port	USB
Size	36.0 x 13.3 x 4.0 cm
Weight	981g (w/ cable), 911g (w/o cable)
System	Windows 7 / 8 / 8.1 / 10 / 11



www.Bloody.com



Scan for E-Manual