



X



Hot-Swappable
BLMS
Bloody Mechanical Switch



Hot-Swappable
587
Mechanical Keyboard

PACKAGE CONTENTS



Gaming Keyboard

* G LED



Detachable
Type-C Cable



12pcs BLMS Red
Plus Switches



Extra
DIY Keycaps



2-in-1 Keycap
& Switch Puller



User Manual

INSTALLATION

CONNECTION

Connect the cable Type-C plug to the keyboard and the USB plug to the computer.
(Note: Use a USB hub or extension cable to connect is not recommended)



SOFTWARE DOWNLOAD

For the best product performance, please download and install the Software from
<http://bloody.com/en/download.php>.

COMBINATION FN KEYS

DEFAULT 10 PRESET LIGHTING EFFECTS

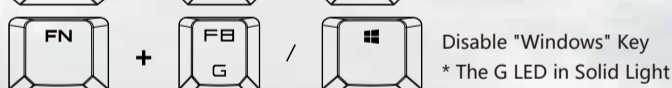
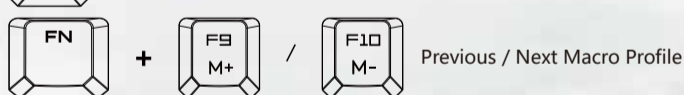
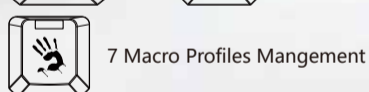
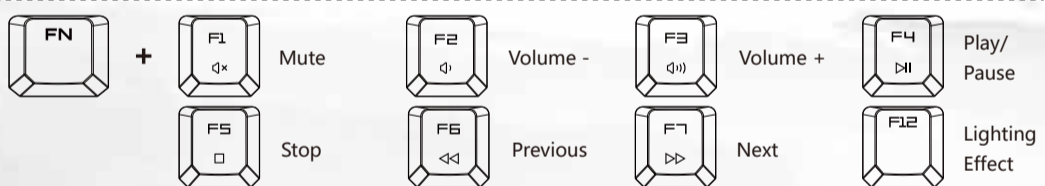

SWAP SWITCH STEP

HOW TO REPLACE SWITCHES?

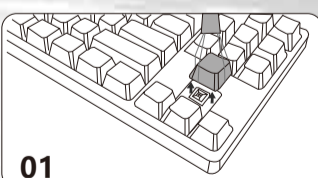

01
Remove the keycaps
with the keycap puller.

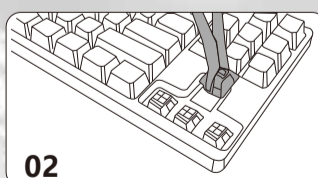

02
Remove the switches
with the switch puller.

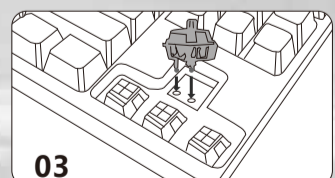

03
Line up the switch pins
with the PCB socket.

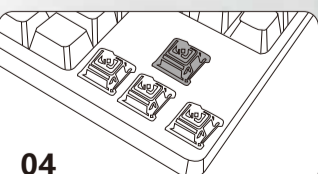

04
Place the switch on the
PCB and integrate it closely.

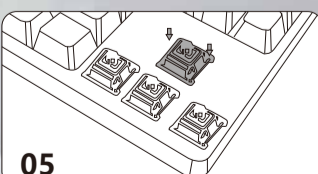

05
Gently press the switch
into place.

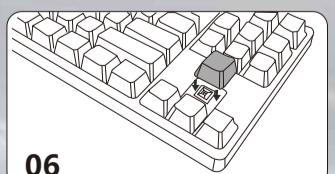

06
Put the keycaps back on
to the keyboard and test it.