



587

QUICK GUIDE



www.bloody.com

PACKAGE CONTENTS



Gaming Keyboard



Keycap Puller



Extra DIY Keycaps



User Manual

INSTALLATION

CONNECTION

Plug the USB cable to the computer USB port.
 (Note: Use a USB hub or extension cable to connect is not recommended.)

SOFTWARE DOWNLOAD

For the best product performance, please download and install the Software from <http://bloody.com/en/download.php>.

COMBINATION FN KEYS

DEFAULT 10 PRESET LIGHTING EFFECTS

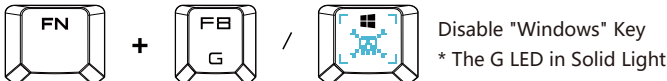
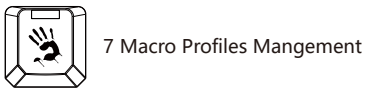
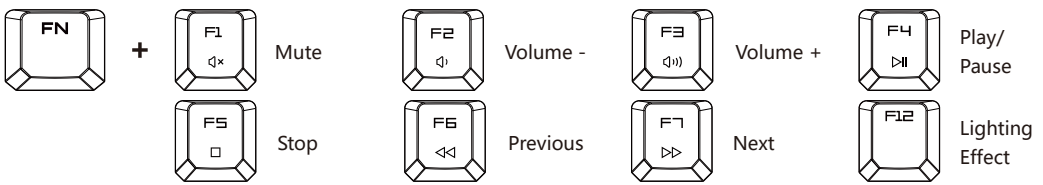
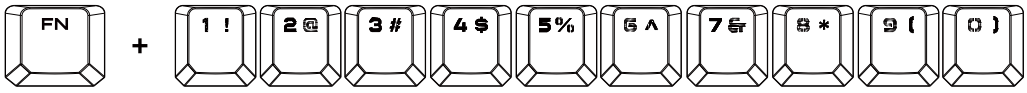

SWAP SWITCH STEP

HOW TO REPLACE SWITCHES?

The keyboard switches are hot-swappable and compatible with most the 3-pin & 5-pin mechanical switches on the market.
 Extra switches are not included in the package.

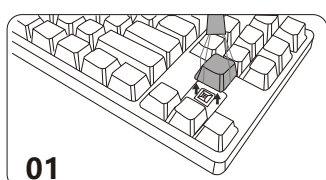

01
 Remove the keycaps with the keycap puller.

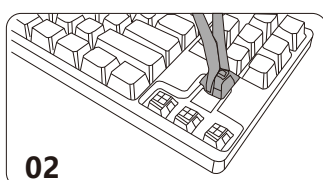

02
 Remove the switches with the switch puller.

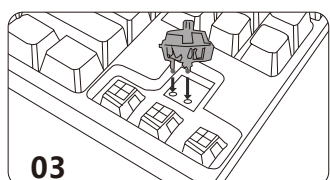

03
 Line up the switch pins with the PCB socket.

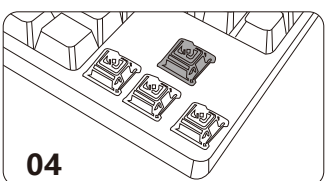

04
 Place the switch on the PCB and integrate it closely.

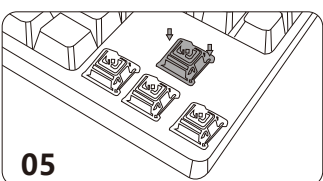

05
 Gently press the switch into place.

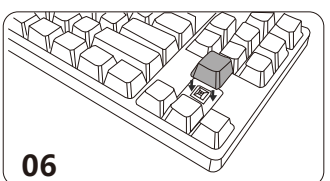

06
 Put the keycaps back on to the keyboard and test it.