



# QUICK START GUIDE

## GP30 USB Gaming Controller



## WHAT'S IN THE BOX



Gaming Controller



User Manual

## KNOW YOUR PRODUCT

- 1 Home Button
- 2 Back Button
- 3 Start Button
- 4 Turbo Button
- 5 Clear Button
- 6 LED Indicator
- 7 3D Left Joystick / LSB
- 8 D-Pad
- 9 3D Right Joystick / RSB
- 10 ABXY Button

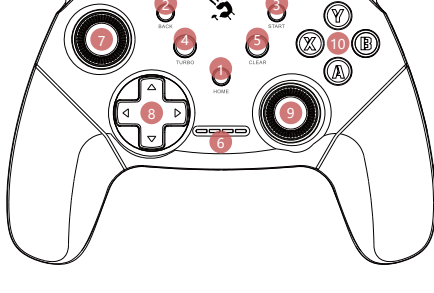
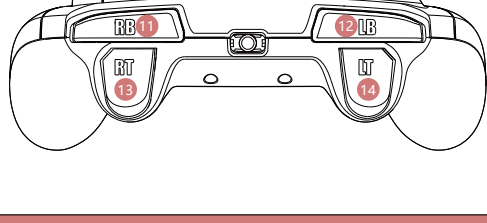

- 11 Right Button (RB)
- 12 Left Button (LB)
- 13 Right Trigger (RT)
- 14 Left Trigger (LT)

## BUTTON FUNCTIONS

Buttons Function	PC/X-Input	PC/D-Input	Android	Switch	PS3
A	1	3	A	B	○
B	2	2	B	A	×
X	3	4	X	Y	△
Y	4	1	Y	X	□
LB	5	5	L1	L	L1
RB	6	6	R1	R	R1
LT	Z Axis	7	L2	ZL	L2
RT	Z Axis	8	R2	ZR	R2
Back	7	9	Select	-	Select
Start	8	10	Start	+	Start
LSB	9	11	TL	TL	L3
RSB	10	12	TR	TR	R3
Home	Home	13	Mode	Home	PS
Turbo	Turbo	Turbo	Turbo	Turbo	Turbo
Clear	Clear	Clear	Clear	Clear	Clear
D-Pad	POV	POV	X/Y	POV	X/Y
LS Joystick	X/Y	X/Y	X/Y	X/Y	X/Y
RS Joystick	X/Y	Z	Z	Z/RZ	Z/RZ

## LED INDICATOR

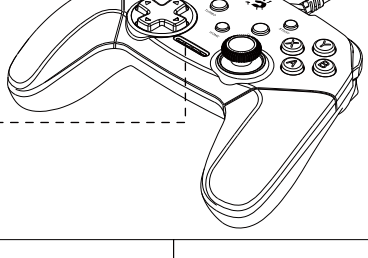
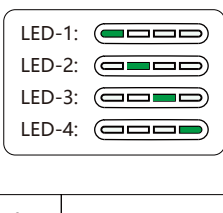

Platform Mode	LED Name	LED Location	How to Connect
PC/X-input	LED-2		Plug and Play
PC/D-input	LED-1		Press Home Button for 5s under X-input Mode
Android/HID	LED-3		Plug and Play
Switch	LED-1		Plug and Play
PS3	LED-1		Plug and Play

## CONNECT WITH PC PLATFORM

### PC/X-Input Mode

- 1 Plug the USB cable to the PC.
- 2 The LED-2 lights up once the Controller is connected.

### Mode Exchange (PC/X-Input to PC/D-Input)

Long press the **[Home]** Button for 3s to turn into D-Input. The LED-1 lights up.

Long press the **[Home]** Button for 3s again to back to X-Input. The LED-2 lights up.

## CONNECT WITH ANDROID PLATFORM

- 1 Plug the USB cable to the Android Device.  
(Smart TV, Set-Top Box, Smart Phone, Tablet based on Android v5.0 and above)  
**Note:** An OTG adaptor will be needed for smartphones and tablets.
- 2 The LED-3 lights up once the Controller is connected.



\* The OTG Adaptor is for demo only, not included in the package.

## CONNECT WITH NINTENDO SWITCH

- 1 Turn on the "Pro Controller Wired Communication" in the console.  
System Settings > Controllers and Sensors > Pro Controller Wired Communication > On  
**Note:** The "Pro Controller Wired Communication" must be turned on before connecting the Controller and the Dock with the USB cable.
- 2 Plug the USB cable into your Nintendo Switch console.
- 3 The LED-1 lights up once the Controller is connected.

**Note:** No Sensor Function and Capture Button in the Switch platform.

In the Switch platform, Button "A" & "B" Exchanged, Button "X" & "Y" Exchanged, Button "Back" change to "-", Button "Start" change to "+".

## CONNECT WITH PLAYSTATION 3

- 1 Plug the USB cable to your PS3.
- 2 The LED-1 lights up once the Controller is connected.

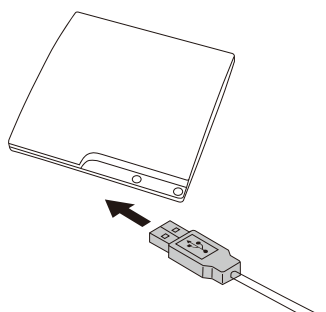

## TURBO & CLEAR FUNCTION SETTING

### Enable Turbo Setting:

- 1 Press and hold on to one or more buttons from A/B/X/Y/LB/RB/LT/RT, then press the **[Turbo]** Button to save the turbo function.
- 2 You may only set one of the combination buttons at the time, to save multiple Turbo settings, please repeat step 1.
- 3 For example: If you like to set button **[A]** to be Turbo function, first press and hold **[A]** and then press the **[Turbo]** Button to save it. If you like to do the same to combination **[Y+△]**, then you need to first press and hold buttons **[Y+△]** and then press the **[Turbo]** Button. Repeat this for all the buttons you like to set.

### Clear Turbo Setting:

- 1 Press one or more buttons with Turbo Function, then press the **[Clear]** Button to clear the Turbo Setting.
- 2 To clear all the previously set Turbo Settings, you need to clear them one by one. Repeat the steps until all keys are cleared.

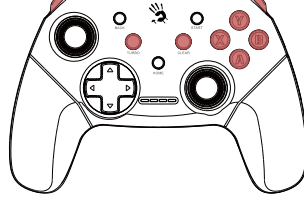

## SPECIFICATIONS

<b>Connection:</b>	USB Wired
<b>System Platform:</b>	PC, Switch, Android, PS3
<b>Cable Length:</b>	180 cm
<b>Size:</b>	155 x 112 x 60 mm
<b>Weight:</b>	216 g
<b>Color:</b>	Sports Blue, Sports Red



[www.Bloody.com](http://www.Bloody.com)



Scan for E-Manual